

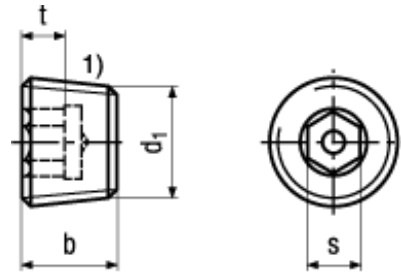

DIN 906



1) Cone 1:16

BN 40

Hex socket pipe plugs

metric fine thread

Steel

zinc plated blue

- ~CSN 021913



Hex socket pipe plugs DIN 906 are not intended to be used for gas and drinking water applications.



- ☞ Proper sealing is depended upon a given medium, pressure, temperature, and mating materials, therefore may not always be guaranteed.
Hence, based on the application, an appropriate sealing compound is recommended.

Article#	d ₁	s	t min.	b
3055893	M8x1	4	4	8
1038354	M10x1	5	4	8
1038362	M12x1,5	6	5	10
1038370	M14x1,5	7	5	10
1038389	M16x1,5	8	5	10
1038397	M18x1,5	8	5	10
1038400	M20x1,5	10	5	10